

The
FURNITURE



C
A
T
A
L
O
G
U
E

by

escowa



Furniture for every need

We primarily manufacture base cabinets for our water dispensers, but our expertise extends far beyond that. Our production includes everything from base cabinets for coffee and vending machines to retail and display furniture, office furnishings, showroom elements, conference storage, and trade fair interiors. We develop solutions that make your everyday life easier, such as adapting ventilation for cooling units or ensuring cabinet security with different locking and tamper-proof solutions.

Customization and flexibility

For us, flexibility is a given. If you have specific requests regarding design, materials, or colors, we will do everything to meet them. With our experience, well-established workflows, and strong collaborations with suppliers, we can create solutions tailored to your needs. This combination of quality, adaptability, and innovation makes us a valued partner for both small and large projects.

Do you have an idea or a specific requirement? Get in touch with us, and we will help you find the right solution!

Our own manufacturing – flexibility and quality in every detail

At Escowa, we have a proud tradition of in-house manufacturing, where quality and craftsmanship take center stage. Our carpentry workshop, in operation since 1993, has grown into a reliable partner in the vending industry and specialized interior production. We continuously invest in modern technology to improve our processes and furniture. With our own painting workshop and a fully equipped production facility, we ensure that every product leaving our workshop meets the highest standards.

Extensive material selection and customized solutions

We collaborate with one of the world's leading suppliers of laminates and board materials, stocking our standard options. Looking for something beyond the ordinary? We are happy to source special laminates upon request! Our range spans from classic Nordic wood species to bold color choices and unique surfaces – everything from retro influences to avant-garde design. We are happy to provide material samples to help you find the right style and feel for your project.



Café stand

Dimensions (WxDxH) 1050x696x2200
 Material Black laminate
 Coolers All in our range



A piece of furniture with endless possibilities. This cabinet offers space for a water cooler, CO2 cylinder, waste bin, and cup dispenser – all in one smart solution.

Integrated lighting illuminates the countertop and the machines placed on top. The back

panel can be customized with an atmospheric image or a message of your choice. Swap the Escowa logo for your own, illuminated in any color you prefer, easily controlled via remote.

Looking for a custom design to perfectly fit your company or event? We've got you covered!

Atlas

Width 495 / 595 / 990 / 1190 mm
 Dimensions (DxH) 595x900 mm
 Material Black or white laminate
 Coolers All in our range



Atlas can be used as a standalone unit or connected. As a standard option, we offer two connected 50 cm or 60 cm cabinets with a single seamless countertop.

Our Atlas cabinet is crafted from high-quality laminate with a sleek black-stained oak laminate door. The standard width options are 50 cm or 60 cm, while depth and height follow industry standards. Upon request, materials and dimensions can be easily customized.

The cabinet is designed to accommodate everything needed for a drinking water solution, including a cooling unit, CO2 cylinder, filter holder, and filter.

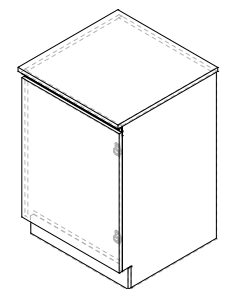

Blubar

Width	323 / 365 / 465 mm
Depth	542 / 570 / 611 mm
Height	900 mm
Material	Black laminate



The Blubar cabinet is custom made in three different sizes to fit our range of Blubar water dispensers, without taking up any extra space.

The base cabinet is made of glossy black laminate.

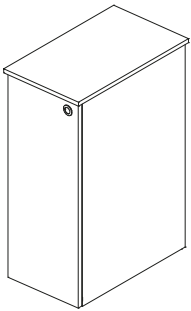

Blusoda

Width	265 / 323 mm
Depth	505 / 525 mm
Height	900 mm
Material	Black laminate



Our Blusoda cabinet is, just like the Blubar cabinet, made in two different sizes. This cabinet, only 265 mm wide in its smallest version, is a great choice when size matters. A small size, that is.

Made in glossy black laminate.

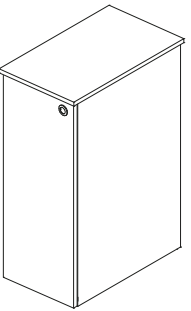

Helios

Dimensions (WxDxH) 450x455x870 mm
 Dim. with divider panel (WxDxH) .. 700x480x900 mm
 Material Black laminate
 Coolers BluNordic 2, Pro1 Eco,
 Pro2 Eco, Pro2 XL Eco

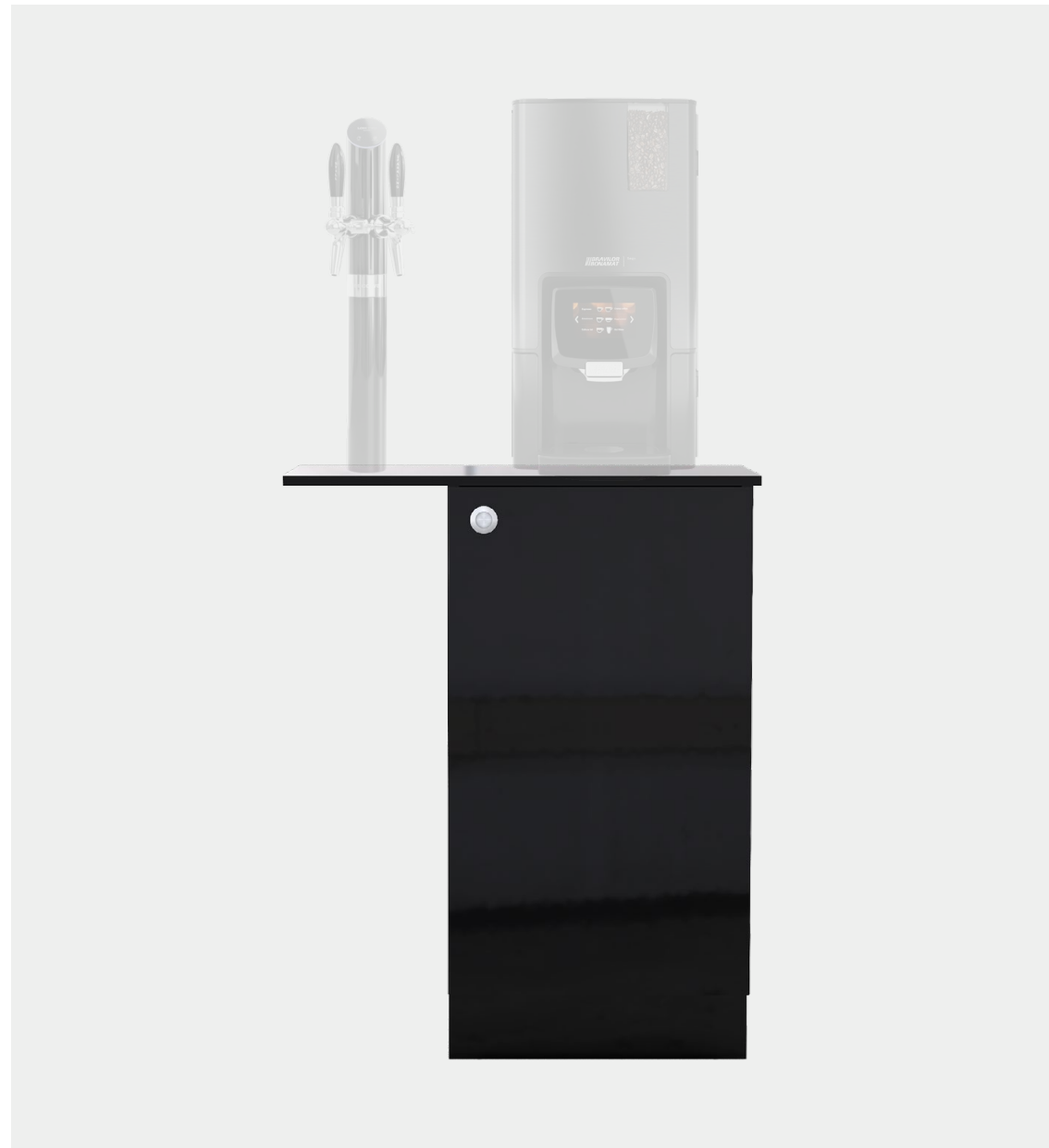

Helios is designed for a water dispenser integrated with a coffee machine but can just as easily be used for either one individually.

It features front ventilation and an extended countertop for faucet installation. The standard finish is glossy black, but it can, of course, be customized in various dimensions and colors to suit the customer's preferences.

The cabinet can also be delivered with a tailored countertop that matches its dimensions – perfect for customers looking for a base cabinet with a tap tower mounted on top.

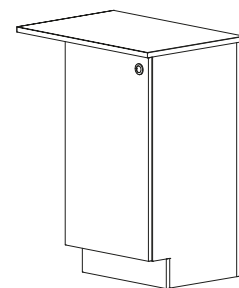

Helios XXL

Dimensions (WxDxH) 450x620x870 mm
 Dim. with divider panel (WxDxH) .. 700x480x900 mm
 Material Black laminate
 Coolers All in our range

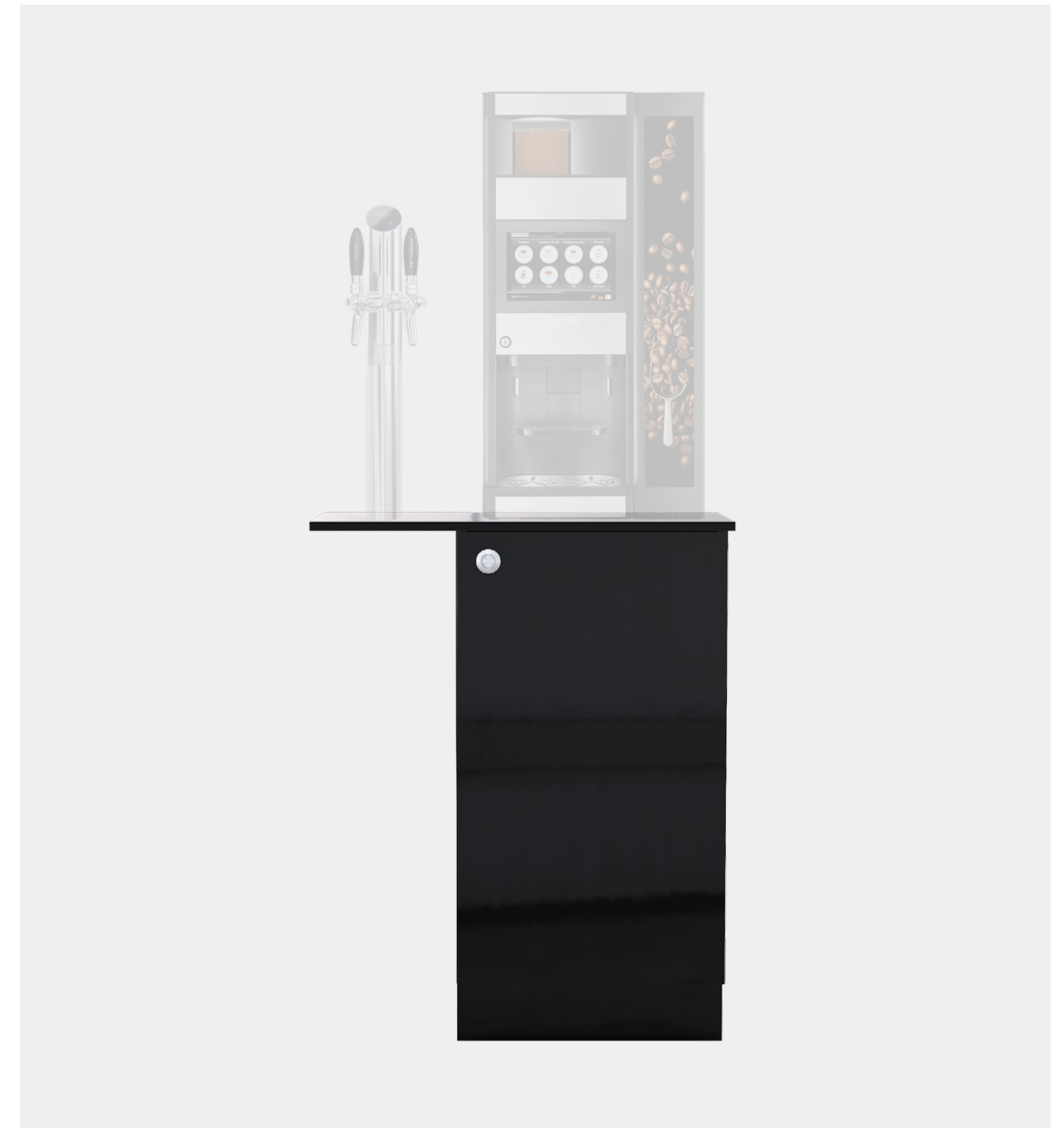

Helios XXL is a deeper version of our Helios base cabinet. Due to its greater depth it can house any cooler in our range.

It features front ventilation and an extended countertop for faucet installation. The standard finish is glossy black, but it can, of course, be customised in various dimensions and colours to suit the customer's preferences.

Helios XXL can also be delivered with a tailored countertop matching its dimensions – ideal for installations with a tap tower mounted on top.

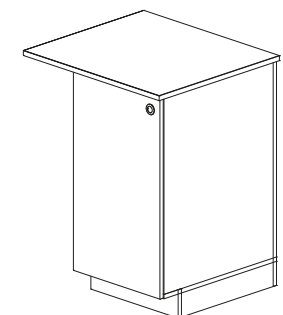

Kronos

Dimensions (WxDxH) 780 (or 1200)x580x900 mm
 Material Black laminate
 Coolers BluNordic 2, Pro1 Eco,
 Pro2 Eco, Pro2 XL Eco

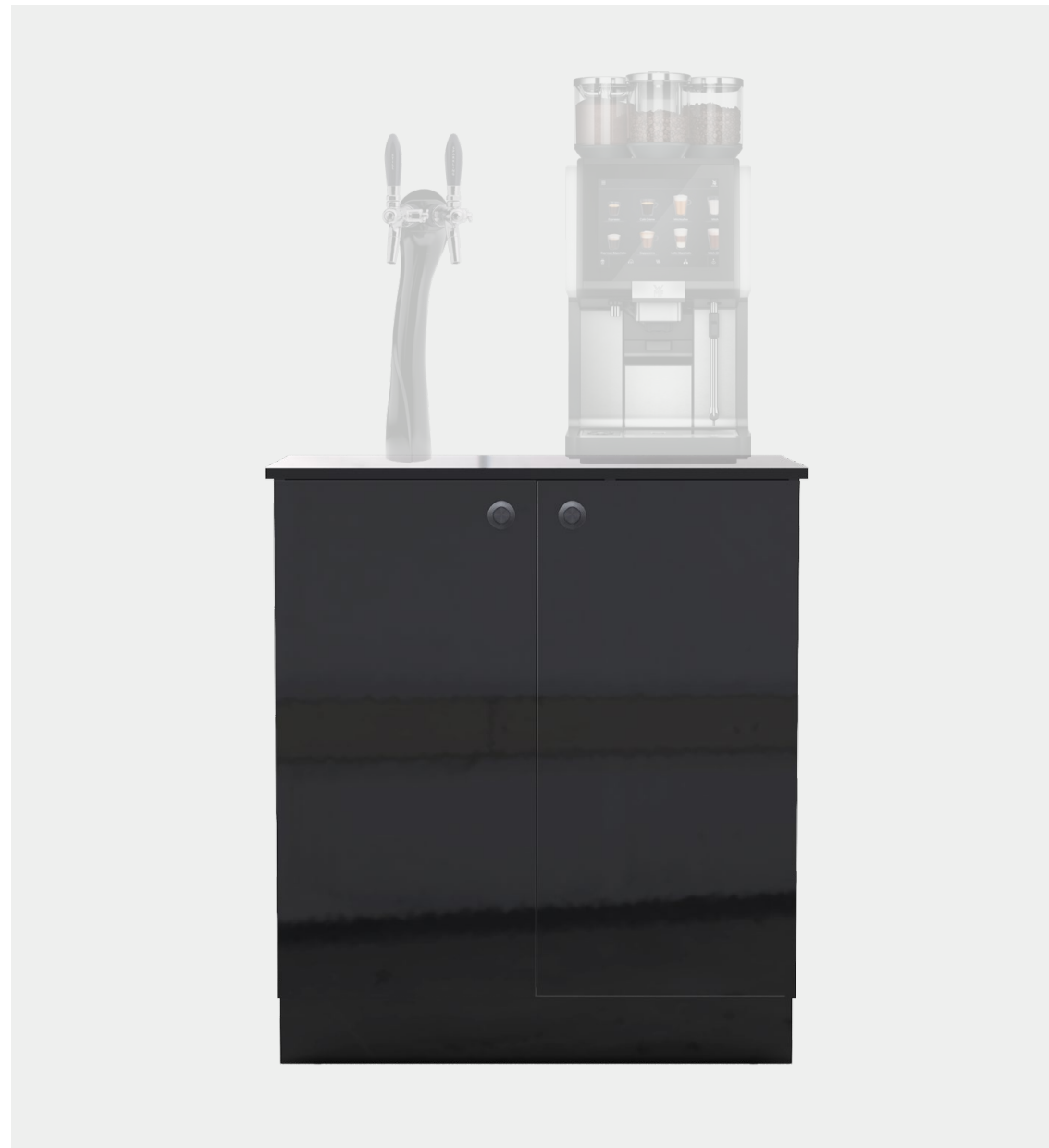

Kronos is a highly stable and intelligent solution for customers who want both coffee and water in a minimal space.

The cabinet is designed with front ventilation, eliminating the need for visible openings with grilles or similar elements. Its size is optimized for efficient shipping – Kronos fits on a half pallet, or why not two on a EUR pallet? A smart choice for the environment.

By default, the cabinet comes in glossy black laminate, but it can, of course, be customized in various dimensions and colors to meet the customer's specific needs.

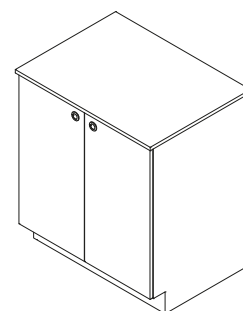

Mono

Dimensions (WxDxH) 480x545x900 mm
 Material Black laminate



As the name suggests, Mono is a single cabinet. Built with sturdy 16 mm material, it features a reinforced interior and a laminated surface.

The cabinet is perfectly suited for a robust coffee machine or as a base cabinet for any desired application.

Of course, the cabinet can be fully customized to meet your customer's specific requirements, both in terms of size and color.

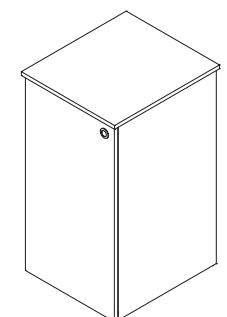

Piccola

Dimensions (WxDxH) 261x440x900 mm
Material Black laminate



Another cabinet specially designed for its namesake in terms of water dispensers, making it a great option when space is limited or when you simply don't want the water dispenser to take up too much room.

Like most of our base cabinets, it comes in a glossy black laminate as standard.

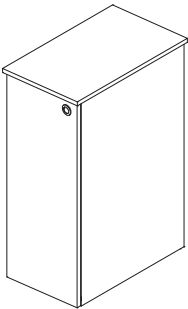

Rebel

Dimensions (WxDxH) 265x580x900 mm
Material Black laminate



The Rebel base cabinet is designed to match the size of a Rebel water dispenser, which fits perfectly on top. The handle to open the cabinet is, fittingly rebellious, not the same as on most of our other base cabinets, but instead a slightly longer profile handle.

However, the cabinet's material stays in line with the rest of our series, featuring the same glossy black laminate.

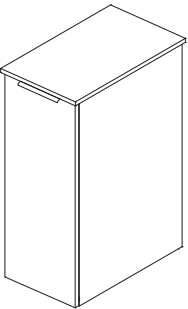

Rock

Dimensions (WxDxH) ... 265x505x900 mm
Material Black laminate



**Need a custom
piece of furniture?
Let's discuss it!**

The Rock water dispenser also has a base cabinet specially designed to match its dimensions. Just like Piccola, Rebel, and the slim version of Blusoda, this cabinet is an excellent choice when space is limited.

Not only does it fit easily into smaller areas, but it also blends seamlessly into most environments thanks to its glossy black laminate.

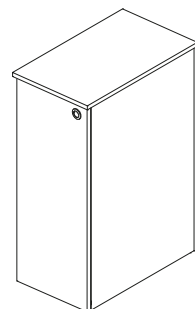

Furniture that cares for forests

Escowa's furniture is made, as far as possible, from recycled wood combined with by-products from other wood production processes, helping reduce the need to cut down forests for material manufacturing. We collaborate with leading laminate manufacturers who uphold high environmental and quality certification standards.

Thanks to the high-quality, durable, and resilient materials, our furniture is well-protected against dents and scratches. The surfaces are water- and chemical-resistant, as well as stain-resistant. This makes maintenance easy, while the long lifespan ensures cost-effective use.

escowa

Escowa AB
Moränvägen 9
186 40 Vallentuna
www.escowa.se